

VELUX "GGL S10" WITH LOW-E GLASS AND ROLLER BLIND (NOT INDICATED ON THIS DRAWING) SPECIFIED ELSEWHERE.
 O/A SIZE: 1600 HIGH x 1140MM WIDE (EXCLUDING FLASHINGS) FOR EACH VELUX

REFER TO DRAWING 9901/18, FIRST FLOOR RETICULATED CEILING PLAN.

VELUX PROPRIETARY FLASHINGS FOR PRODUCT "GGL" WITH FLAT INTERLOCKING ROOF TILES INDICATED. (REFER TO MANUFACTURER'S LITERATURE)

225x50 TREATED S/W RAFTER TIMBER FINISHED TEXTURE TO MATCH CEILING COVER PIECES.
 FINISH: STAIN - SIKKENS REF. CETOL T.S. COLOUR 60.07.45T

50x25 TREATED S/W COVER PIECE REFER TO NOTES DWG 9901/50
 FINISH: STAIN - SIKKENS REF. CETOL T.S. COLOUR 60.07.45T.

CUT 50x75MM TREATED S/W BATTEN

600 GAUGE POLYETHYLENE VAPOUR BARRIER BARRIER NAILED TO BATTENS/RAFTERS/TRIMMERS, JOINTS LAPPED AND SEALED.

9MM INTERIOR GRADE BEECH VENEERED PLYWOOD WITH BALANCING TO REAR. LAY WITH GRAIN IN SAME DIRECTION AS MAIN ROOF. INVISIBLY FIX WITH OVAL SECTION 'LOST HEAD' NAILS PUNCHED IN AND FILLED.
 FINISH: CLEAR SEMI-MATT POLYURETHANE SEAL.

225 x 50 TREATED S/W TRIMMER
 CUT 75 x 75 TREATED S/W BATTEN
 LANDMARK SLATE TOP SLATE (7605) BY REDLAND ROOFING MECHANICALLY FIXED.
 SOFTWOOD COVER PIECE.

1 TYPICAL SECTION THROUGH VELUX WINDOWS. 1:5.

72

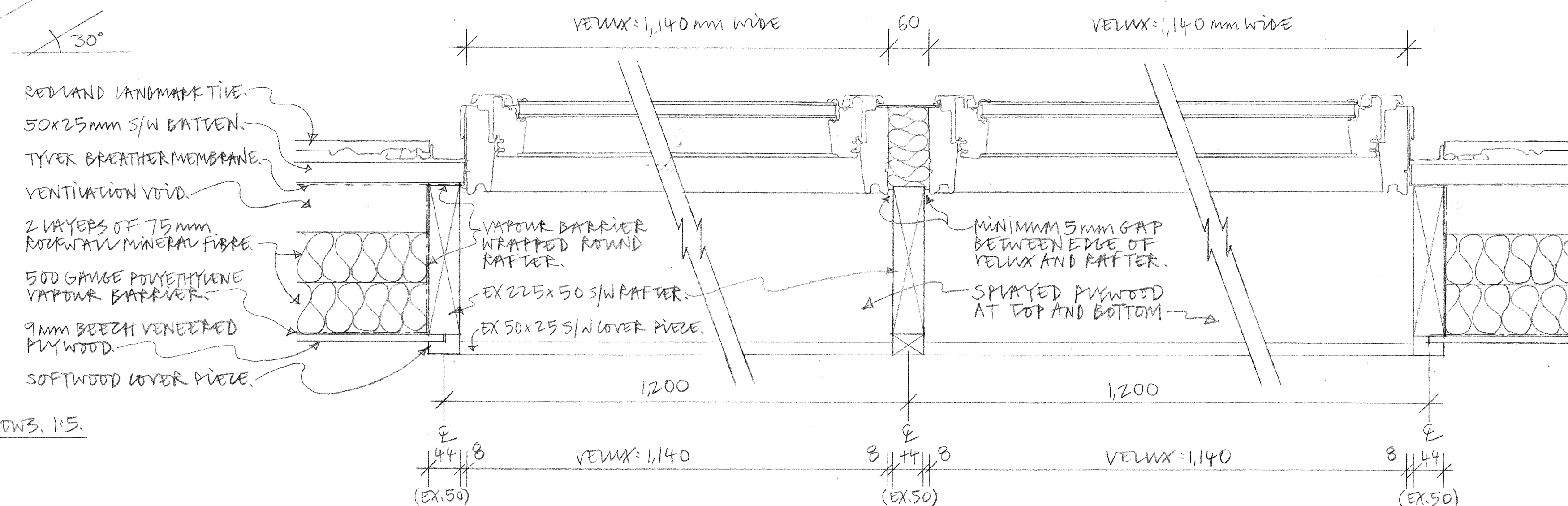
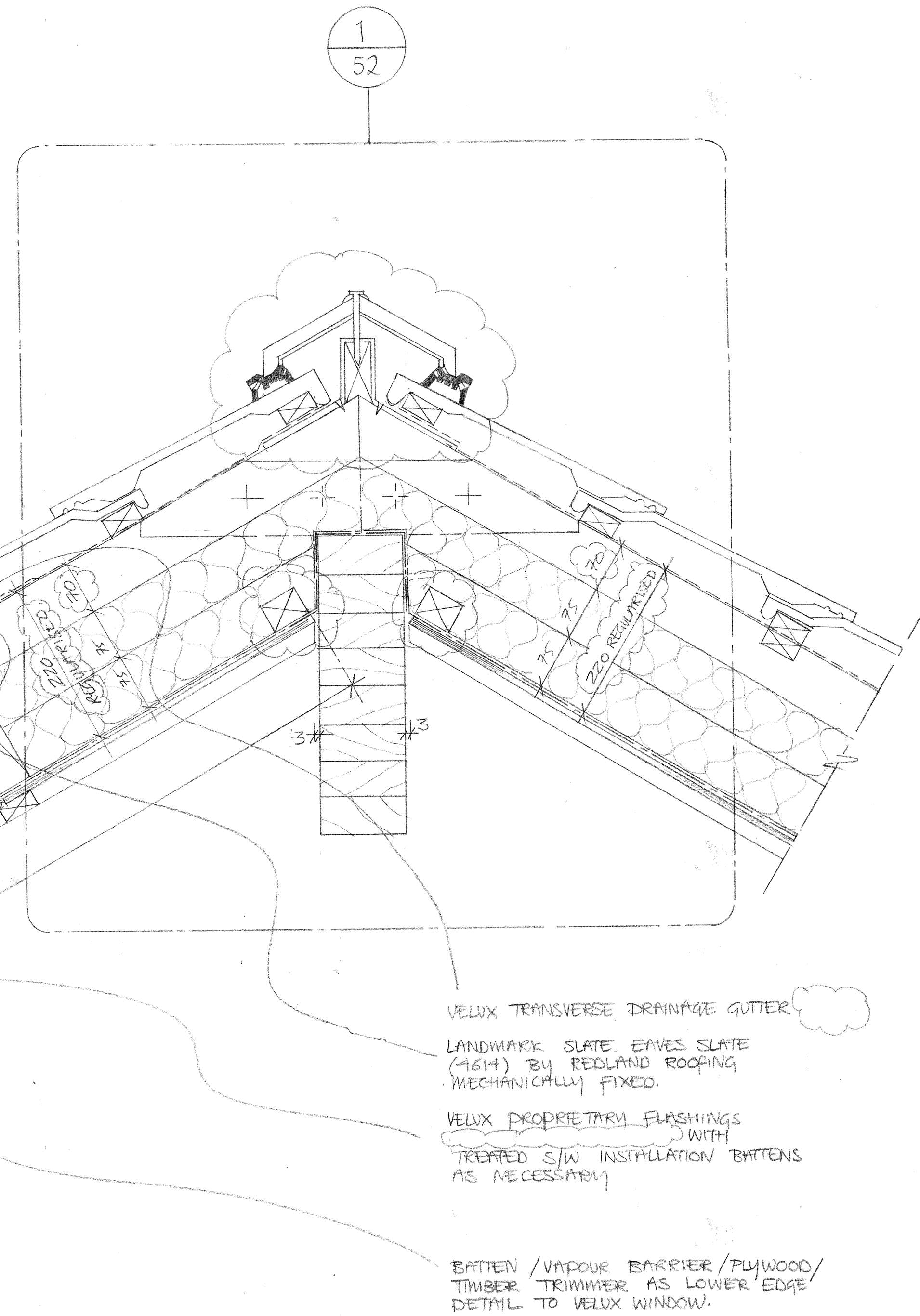

GENERAL NOTES:

1. DRAWINGS TO BE READ IN CONJUNCTION WITH STRUCTURAL ENGINEERS, M+E AND ARCHITECTS, DRAWINGS & SPECIFICATIONS.
2. ALL CONSTRUCTION METHODS TO COMPLY WITH HEALTH AND SAFETY REGULATIONS AND ALL OTHER STATUTORY REGULATIONS.
3. ALL WORKS TO COMPLY WITH RELEVANT BRITISH AND EUROPEAN STANDARDS.
4. SHOP DRAWINGS MAY BE REQUIRED; TO BE INSPECTED BY ARCHITECT AND ENGINEERS.
5. DO NOT USE WOOD PRESERVATIVE TREATMENTS WHICH ARE CORROSIVE TO ALUMINIUM, INCLUDING THOSE CONTAINING COPPER AND MERCURY SALTS.

B 26.02.02 KOC RIDGE UPDATED			
A	14.11.01	BY	PLAN ADDED + SOME DETAILS.
REVISION	DATE	INITIALS	DETAILS

CLIENT	REEDSPACE LTD.
PROJECT	EASTERN ROAD, BRACKNELL.
DRAWING	TYPICAL SECTION THROUGH VELUX WINDOWS
SCALE	1:5
DRAWING NO.	9901/72B
DATE	MAY '01
DRAWN BY	KOC

Do not scale drawing. Dimensions to be verified on site. This drawing is the property of Bill Reed Architecture and they reserve the copyright. The drawing is issued on the condition that it is not copied, reproduced, retained or disclosed to any unauthorised person, either wholly or in part, without the consent in writing of Bill Reed Architecture.