

CODE 5 LEAD ON WATERPROOF BUILDING PAPER TO BS 1521 CLASS A FINISH TO LEAD: SILICATE COMBINATION OIL (SEE GENERAL NOTE 6)

TREATED WOOD CORED ROLLS NAILED TO TIMBER SUBSTRATE

19MM WBP PLYWOOD

50MM VENTILATION SPACE

75 x 50 MM TREATED S/W BATTENS FIXED TO INSULATION

"TYVEK 2480 B SOLID" BREATHER MEMBRANE BY OVENS CORNING.

70MM KINGSPAN "THERMAROOF TR31" RIGID URETHANE INSULATION WITH INTEGRAL 6MM WBP PLY UPPER FACING LAYO ALONG THE JOISTS AND CUT AROUND 200 x 100 S/W BEAM. ALLOW FOR 60x50 TREATED S/W NOGGINS TO FULLY SUPPORT ALL UNSUPPORTED FREE EDGES. SEAL JOINTS BETWEEN BOARDS AND JOISTS/NOGGINS WITH CONTINUOUS FLEXIBLE WATERPROOF SEALANT TO ARCHITECTS APPROVAL.

(INTEGRAL VAPOUR BARRIER TO BOTTOM FACE OF INSULATION)

TREATED S/W FIRTINGS 50MM WIDE AT 600 CENTRES FIXED TO TREATED S/W JOISTS 125 x 50 MM TO ACHIEVE 1:60 FALLS.

CAT 2 RECESSED DOWNLIGHTER

9MM BEECH VENEERED INTERIOR GRADE PLYWOOD WITH BALANCING TO RETR.

4MM EXPANSION GAP TO LONG EDGES, AND 2-3MM GAP TO SHORT EDGES. GRAIN TO RUN PARALLEL WITH LONG EDGES. FINISH: CLEAR SEMI-MATT POLYURETHANE SEAL.

9MM BEECH VENEERED INTERIOR GRADE PLYWOOD. (SEE NOTE ABOVE) CONCEALED FIXINGS TO ARCHITECTS APPROVAL

38 x 38 TREATED S/W BATTEN

225 x 50 TREATED S/W RAFTER WITH STAIN FINISH. SIKKENS REF. HLS / FILTER 7 ROSEWOOD.

TIMBER FINISHED TEXTURE TO MATCH CEILING COVER PIECES.

GLAZED "SHOPFRONT" FIXED AT HEAD AND CILL. PFC ALUMINIUM LOUVRE (DOOR TO LOUVRE NOT SHOWN) FIXED AT HEAD, CILL AND SIDES.

1/65 TYPICAL SECTION (PART) THROUGH LEAD CANOPY 1:5

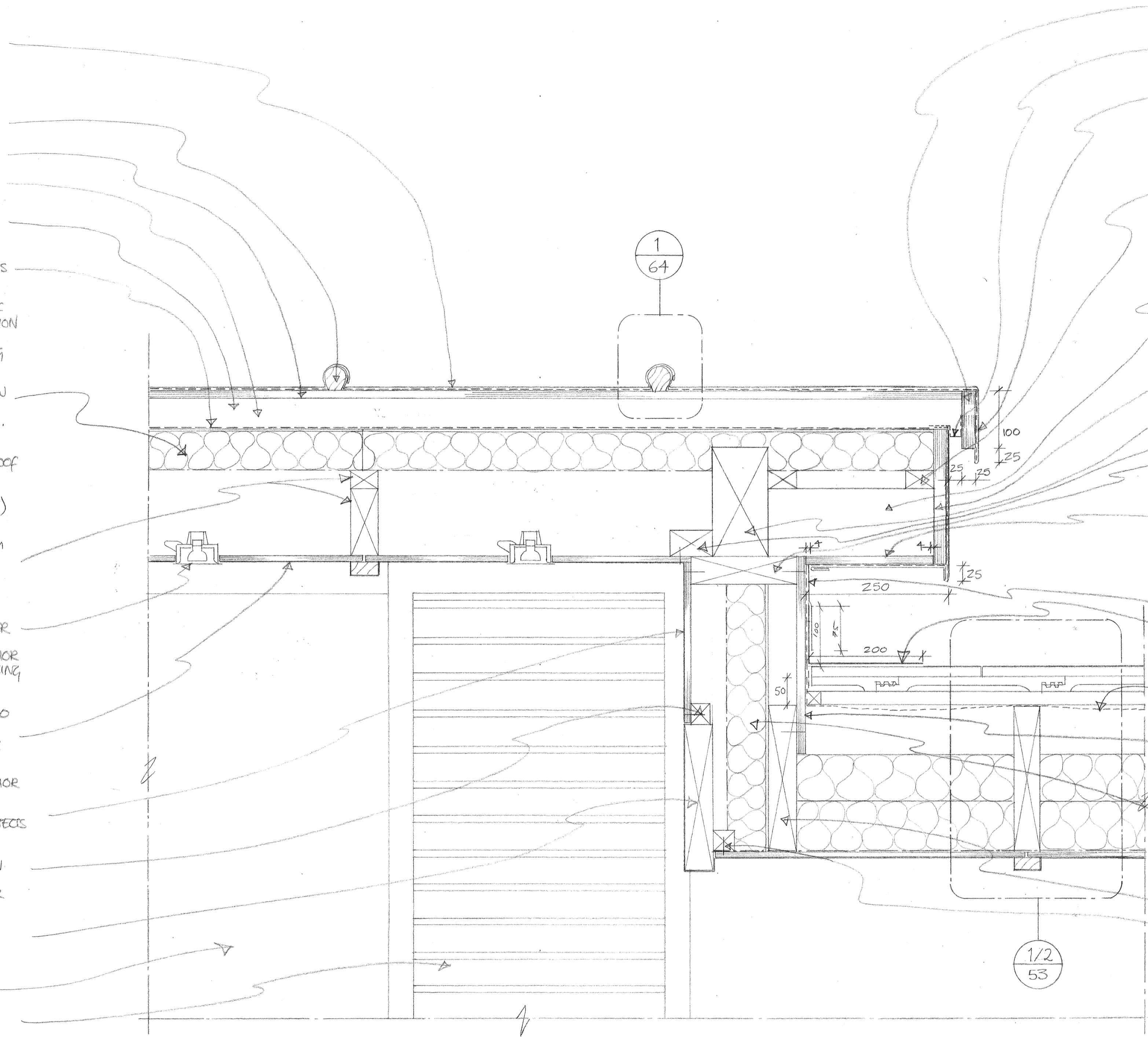

100 x 25 MM WBP PLYWOOD FIXED TO 75 x 50 BATTENS

FLYSCREEN TO 26MM CONTINUOUS VENTILATION STRIP

CODE 5 LEAD ON WATERPROOF BUILDING PAPER TO BS 1521 CLASS A FINISH: PATINATION OIL SEE DRAWING 9901/62

50 x 32 TREATED S/W NOGGINS TO SUPPORT INSULATION. APPLY CONTINUOUS FLEXIBLE WATERPROOF SEALANT TO ALL JUNCTIONS OF INSULATION AND NOGGINS. SEALANT TO ARCHITECTS APPROVAL.

125 x 50 MM TREATED S/W SPROCKETS AT 600 CENTRES FIXINGS TO S.E. DETAILS.

250 x 25 MM WBP PLYWOOD FASCIA FIXED TO SPROCKETS AND BATTENS, WITH CODE 5 LEAD ON WATERPROOF BUILDING PAPER. 200 x 100 TREATED S/W BEAM. FIXINGS TO S.E. DETAILS.

75 x 50 TREATED S/W BATTEN

190 x 50 TREATED S/W

19MM WBP PLYWOOD WITH CODE 5 LEAD ON WATERPROOF BUILDING PAPER. FINISH TO LEAD: PATINATION OIL. REFER TO DRAWING 9901/62 FOR LEAD DETAILS.

CODE 4 LEAD ON WATERPROOF BUILDING PAPER BS 1521 CLASS A FINISH: PATINATION OIL

CODE 4 LEAD FLASHING (SEE DNG. 9901/62)

"TYVEK 2480 B SOLID" BREATHER MEMBRANE TURNED UP 50MM VERTICALLY AND HELD IN PLACE BY 25 x 25 TREATED S/W BATTEN.

19MM WBP PLYWOOD

70MM KINGSPAN "THERMAROOF TR31" WITH INTEGRAL VAPOUR BARRIER. APPLY CONTINUOUS FLEXIBLE WATERPROOF SEALANT (TO ARCHITECTS APPROVAL) TO ALL JUNCTIONS OF INSULATION AND TIMBER.

225 x 50 TREATED S/W CUT RAFTER FIXINGS TO S.E. DETAILS.

38 x 38 TREATED S/W BATTEN.

GENERAL NOTES

- DRAWINGS TO BE READ IN CONJUNCTION WITH STRUCTURAL ENGINEERS, M/E AND ARCHITECTS DRAWINGS AND SPECIFICATIONS.
- ALL CONSTRUCTION METHODS TO COMPLY WITH HEALTH AND SAFETY REGULATIONS AND ALL OTHER STATUTORY REGULATIONS.
- ALL WORKS TO COMPLY WITH RELEVANT BRITISH AND EUROPEAN STANDARDS.
- SHOP DRAWINGS MAY BE REQUIRED; TO BE INSPECTED BY ARCHITECT AND ENGINEERS.
- ALL LEADWORK FIXINGS TO COMPLY WITH GOOD PRACTICE AS DESCRIBED IN THE LATEST EDITIONS OF "THE LEAD SHEET MANUAL" PUBLISHED BY THE LEAD SHEET ASSOCIATION, UNLESS AGREED OTHERWISE.
- APPLY TO ALL VISIBLE LEAD TO LEAD CANOPY A SILICATE COATING OF PATINATION OIL, EVENLY IN ONE DIRECTION AND IN DRY CONDITIONS. (INCLUDING FLASHINGS)
- USE LEAD CLIPS CUT FROM SHEETS OF THE SAME CODE AS THE SHEET BEING SECURED. LENGTH AND CENTRES TO SUIT DETAIL AND MODERATE EXPOSURE.
- FIXING LEAD: DO NOT USE INTERMEDIATE FIXINGS (EXCEPT WHERE NECESSARY TO SOFFIT). FIX INTO TIMBER SUBSTRATES WITH STAINLESS STEEL (AUSTENITIC) CLOUT NAILS, NOT LESS THAN 19MM LONG. DO NOT USE COPPER OR COPPER ALLOY NAILS.
- DO NOT USE WOOD PRESERVATIVE TREATMENTS WHICH ARE CORROSIVE TO ALUMINIUM, INCLUDING THOSE CONTAINING COPPER AND MERCURY SALTS.
- IF MORE ECONOMICAL TO USE A DIFFERENT CODE OF LEAD TO CANOPY CHECKS AND FLASHINGS RATHER THAN CODE 4; THEN CONTRACTOR TO REQUEST ARCHITECTS APPROVAL PRIOR TO ORDERING LEAD.

A 11.05.01 KO/C GEN. NOTE 4 REVISED

REVISION	DATE	INITIALS	DETAILS

CLIENT

FEEDSPACE LTD.

PROJECT

EASTERN ROAD, BRACKNELL.

DRAWING

TYPICAL SECTION (PART) THROUGH LEAD CANOPY.

UNITS F, G, H & K

SCALE

1:5

DRAWING NO.

9901/65 A

DATE

13 APRIL 01

DRAWN BY

KO/C

Do not scale drawing. Dimensions to be verified on site. This drawing is the property of Bill Reed Architecture and they reserve the copyright. The drawing is issued on the condition that it is not copied, reproduced, retained or disclosed to any unauthorized person, either wholly or in part, without the consent in writing of Bill Reed Architecture.

BILL REED ARCHITECTURE
44 KINGS TERRACE, LONDON NW1 OUR TELEPHONE 071-387 4521 FAX 071-387 2294

